

CLASS CC FUSES



KLDR Series

600 VAC/300 VDC • Time-Delay • 1/10-30 Amperes



Description

KLDR fuses are time-delay fuses designed to protect control transformers, solenoids and similar inductive components with high magnetizing currents during the first half-cycle. They provide excellent protection of motor branch circuits containing IEC or NEMA rated motor controllers or contactors.

Specifications

Voltage Ratings:	AC:	600 V
	DC:	300 V
Interrupting Ratings:	AC:	200 kA rms symmetrical
	DC:	20 kA
Ampere Range:		1/10 – 30 A
Approvals:	AC:	Standard 248-4, Class CC UL Listed 1/10-30 A (File No. E81895) CSA Certified 1/10-30 A (File No. LR29862)
	DC:	Littelfuse self-certified

Ordering Information

AMPERE RATINGS				
1/10	6/10	1 8/10	4 1/2	10
1/8	3/4	2	5	12
15/100	8/10	2 1/4	5 6/10	15
3/16	1	2 1/2	6	17 1/2
2/10	1 1/8	2 8/10	6 1/4	20
1/4	1 1/4	3	7	25
3/10	1 4/10	3 2/10	7 1/2	30
4/10	1 1/2	3 1/2	8	—
1/2	1 6/10	4	9	—

SERIES	AMPERAGE	CATALOG NUMBER	SYSTEM NUMBER
KLDR	10	KLDR010	KLDR010.T

Web Resources

For additional information, visit:

www.littelfuse.com/klDR

Recommended Fuseholders

LPSC Series
L60030C Series

KLKR Series

600 VAC/300 VDC • Fast-Acting • 1/10-30 Amperes



Description

KLKR Series Class CC fuses are fast-acting fuses intended for general purpose branch circuit protection. Their compact size, fast-acting overload response, and highly current-limiting design make them ideal for use in OEM equipment and control panels.

Specifications

Voltage Ratings:	AC:	600 V
	DC:	300 V
Interrupting Ratings:	AC:	200 kA rms symmetrical
	DC:	20 kA
Ampere Range:		1/10 – 30 A
Approvals:	AC:	Standard 248-4, Class CC UL Listed 1/10-30 A (File No. E81895) CSA Certified 1/10-30 A (File No. LR29862)
	DC:	Littelfuse self-certified

Ordering Information

AMPERE RATINGS				
1/10	1/2	2 1/2	6	12
1/8	3/4	3	7	15
2/10	1	3 1/2	8	20
1/4	1 1/2	4	9	25
3/10	2	5	10	30

SERIES	AMPERAGE	CATALOG NUMBER	SYSTEM NUMBER
KLKR	12	KLKR012	KLKR012.T

Web Resources

For additional information, visit:

www.littelfuse.com/klkr

Recommended Fuseholders

LPSC Series
L60030C Series



CLASS CC/CD DIMENSIONS AND CURRENT-LIMITING EFFECTS

Dimensions in inches (mm)

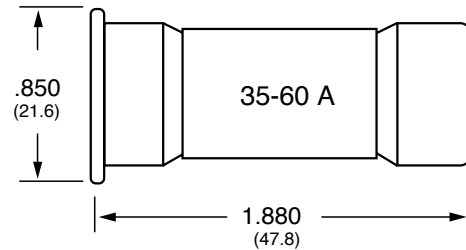
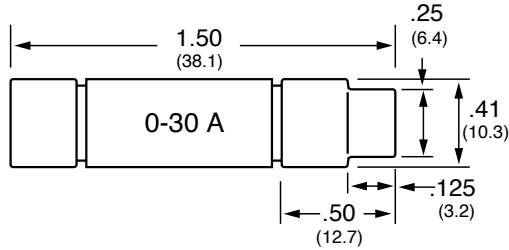

Current-Limiting Effects of CCMR (600 V) fuses

SHORT CIRCUIT CURRENT*	APPARENT RMS SYMMETRICAL CURRENT FOR VARIOUS FUSE RATINGS							
	2 A	4 A	6¼ A	10 A	12 A	15 A	20 A	30 A
5,000	160	190	330	370	525	600	625	750
10,000	180	220	400	440	600	700	725	875
15,000	200	250	430	480	675	775	800	950
20,000	220	260	460	520	720	825	850	1,000
25,000	230	280	480	550	750	850	900	1,050
30,000	240	290	500	570	800	900	950	1,125
35,000	245	300	520	590	825	925	975	1,175
40,000	255	310	550	600	850	975	1,000	1,200
50,000	260	330	570	640	875	1,000	1,100	1,300
60,000	280	340	600	670	900	1,050	1,125	1,350
80,000	300	360	625	700	1,000	1,125	1,200	1,400
100,000	310	380	650	750	1,050	1,200	1,250	1,500
150,000	340	420	700	800	1,150	1,300	1,400	1,600
200,000	350	440	750	850	1,200	1,400	1,450	1,750

*Prospective RMS Symmetrical Amperes Short-Circuit Current
Note: Data Derived from Peak Let-Thru Curves

Peak Let-Thru Curve KLCDR



Peak Let-Thru Curve KLKR

